

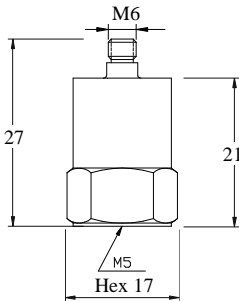

Charge Output Economic Version Accelerometer

Model NTI-24110



DYNAMIC

| | | |
|------------------------|-------|---------------|
| Sensitivity | ----- | 30 pC/g |
| Measurement Range | ----- | ± 1500 g peak |
| Amplitude Nonlinearity | ----- | 1 % |
| Frequency Range ± 10% | ----- | 0.5 – 6 kHz |
| Resonance Frequency | ----- | 23 kHz |
| Transverse Sensitivity | ----- | ≤ 5 % |

ELECTRICAL

| | | |
|---------------------------------------|-------|------------------------|
| Capacitance | ----- | 700 pF |
| Sensing Insulation Resistance | ----- | ≥ 1x10 ¹¹ Ω |
| Mounting Ground Insulation Resistance | ----- | ≥ 1x10 ⁸ Ω |

ENVIRONMENT

| | | |
|--|-------|-----------------------------|
| Maximum Vibration | ----- | 2000 g peak |
| Maximum Shock | ----- | 2500 g peak |
| Operation Temperature (Domestic Ceramic) | --- | -40 to 320°F / -40 to 160°C |
| Temperature Response | ----- | See Graph |
| Sealing | ----- | Epoxy |
| Base Strain Sensitivity | ----- | 0.001 g/μ strain |

PHYSICAL

| | | |
|-----------------------------|-------|-----------------|
| Sensing Element | ----- | Ceramic / Shear |
| Housing Material | ----- | Stainless Steel |
| Output Connector / Position | ----- | M6 / Top |
| Mounting Thread | ----- | M5 |
| Weight | ----- | 28 gram |

ACCESORIES SUPPLIED

- Ø 3 mm x 1 m Low Noise Cable with M6 / M5 Connectors
- M5 – M5 Mounting Stud
- Calibration Certificate

Note: Output connector and mounting thread can be changed to English 10-32 thread by request.

